

INDICATIVE LAYOUT

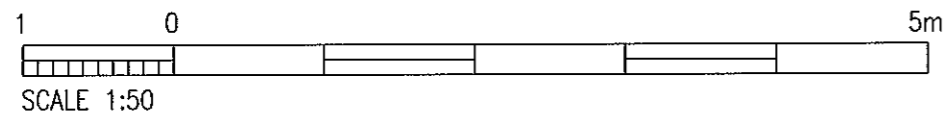
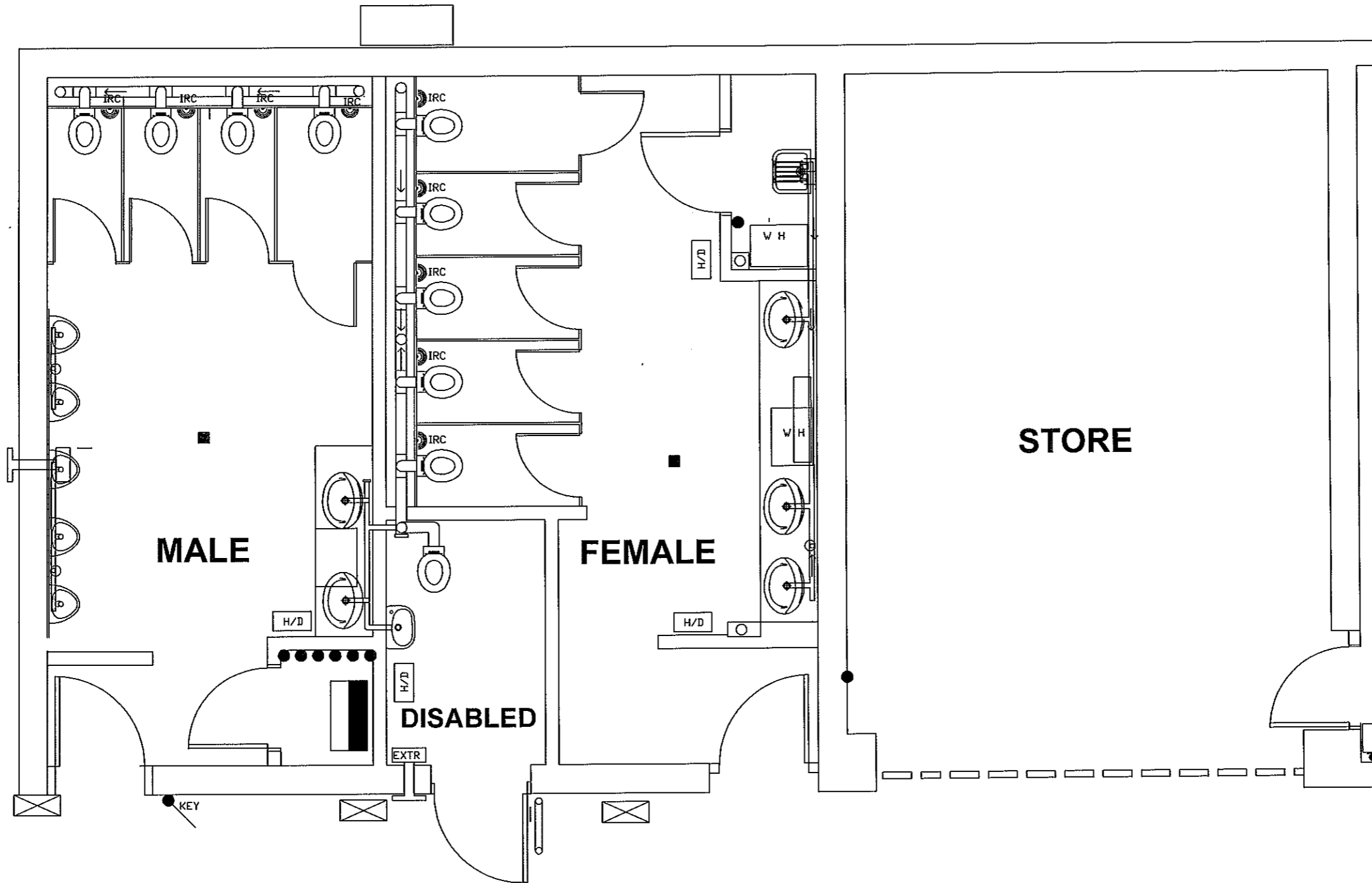

ASHFORD BOROUGH COUNCIL CUSTOMERS HOMES & PROPERTY Civic Centre, Tannery Lane, Ashford, Kent, TN23 1PL tel: 01233 331111 fax: 01233 645654		PROJECT TRANSFER OF PUBLIC TOILETS			
		DRAWING TITLE RECREATION GROUND RD PUBLIC TOILETS, TENTERDEN, INDICATIVE GENERAL ARRANGEMENT			
DRAWN JM	AUTOCAD FILE FILE No.	DATE FEB 2013	SCALE AS SHOWN	DRG.No. DRG No.	REV. -